

Continental View Estates Homeowner's Association

Board Meeting Minutes

www.cvehoa.com

June 8, 2019

Board Members in Attendance:

President – Michelle Baker

Treasurer – John Helton

At Large – Dan Nichols

Secretary – JoD Splett

Business:

1. Tennis Courts
 - a. Resurfacing is complete.
 - b. Pickleball lines were not drawn on the courts due to a miscommunication.
 - c. John proposed buying court line paint and painting lines on one court ourselves later this summer.
 - d. The lock combination remains the same (4802).
2. Hays Street Island Renovation
 - a. Michelle trimmed four branches from one tree that were spreading into the roadway.
 - b. The drip system in the island should be operational.
 - c. The island is 168' long and 7' wide.
 - d. Existing landscaping rocks (large and small) will not be removed, but new rocks will be added where needed.
 - e. Board members reviewed a plan put forward by the landscaping committee (Figure 1).
 - i. The two baby blue spruce trees anchoring both ends of the island were thought to be too large for safety.
 - ii. The board members were concerned about the amount of water required for the plants proposed.
 - f. Michelle Baker developed an alternate plan to be discussed with the landscaping committee (Figure 2). The proposed plan includes only plants that are considered drought resistant for xeriscaping.
 - i. Karl Foester grass (9 plants)
 - ii. Blue grama grass (12-18 plants)
 - iii. Magenta ice plant (6 plants)
 - iv. Low growing sumac shrubs (2 plants)
 - v. Columbines (5 plants)
 - vi. Spreading daisies (10 plants)

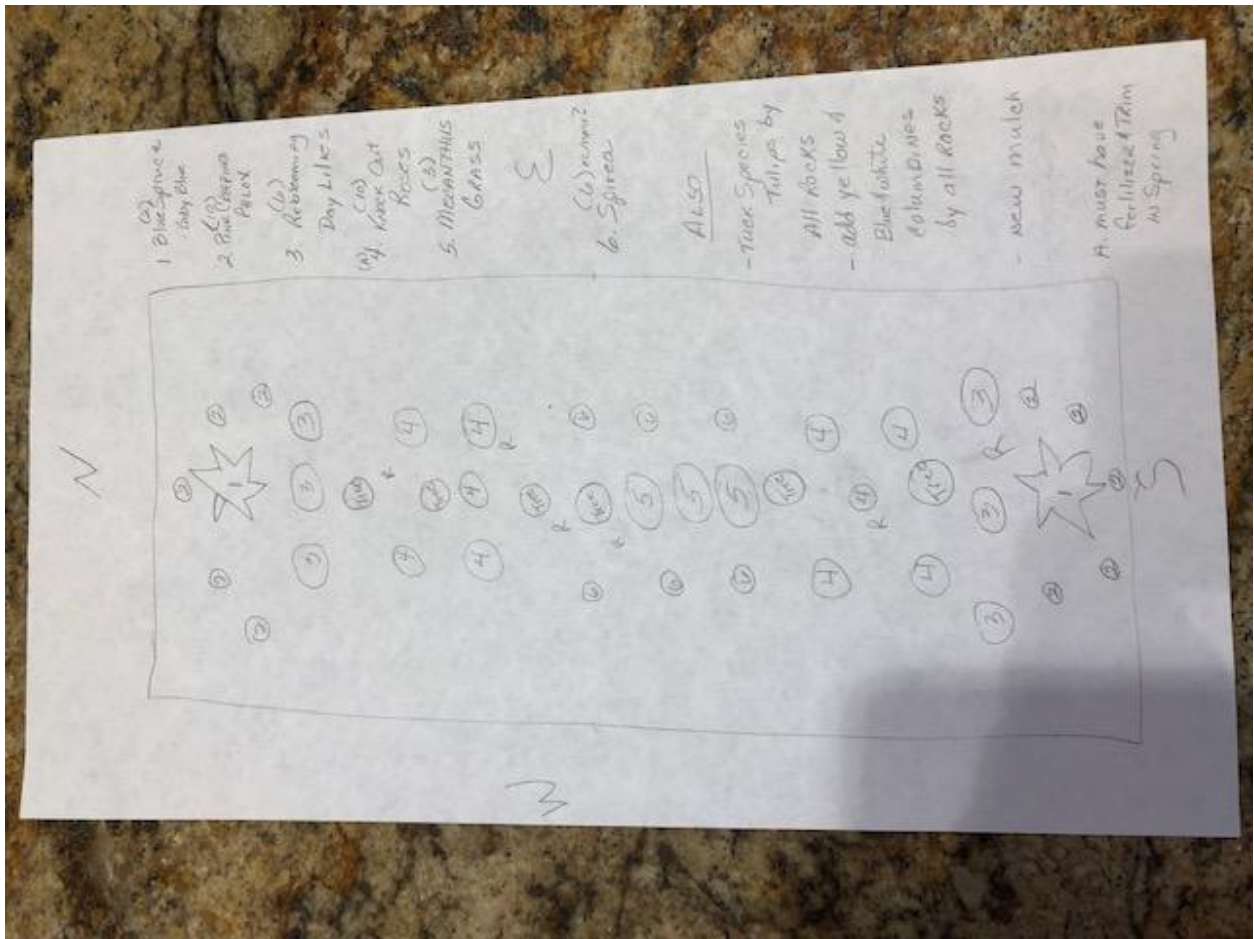

Figure 1. Landscape plan provided by Grounds Committee.

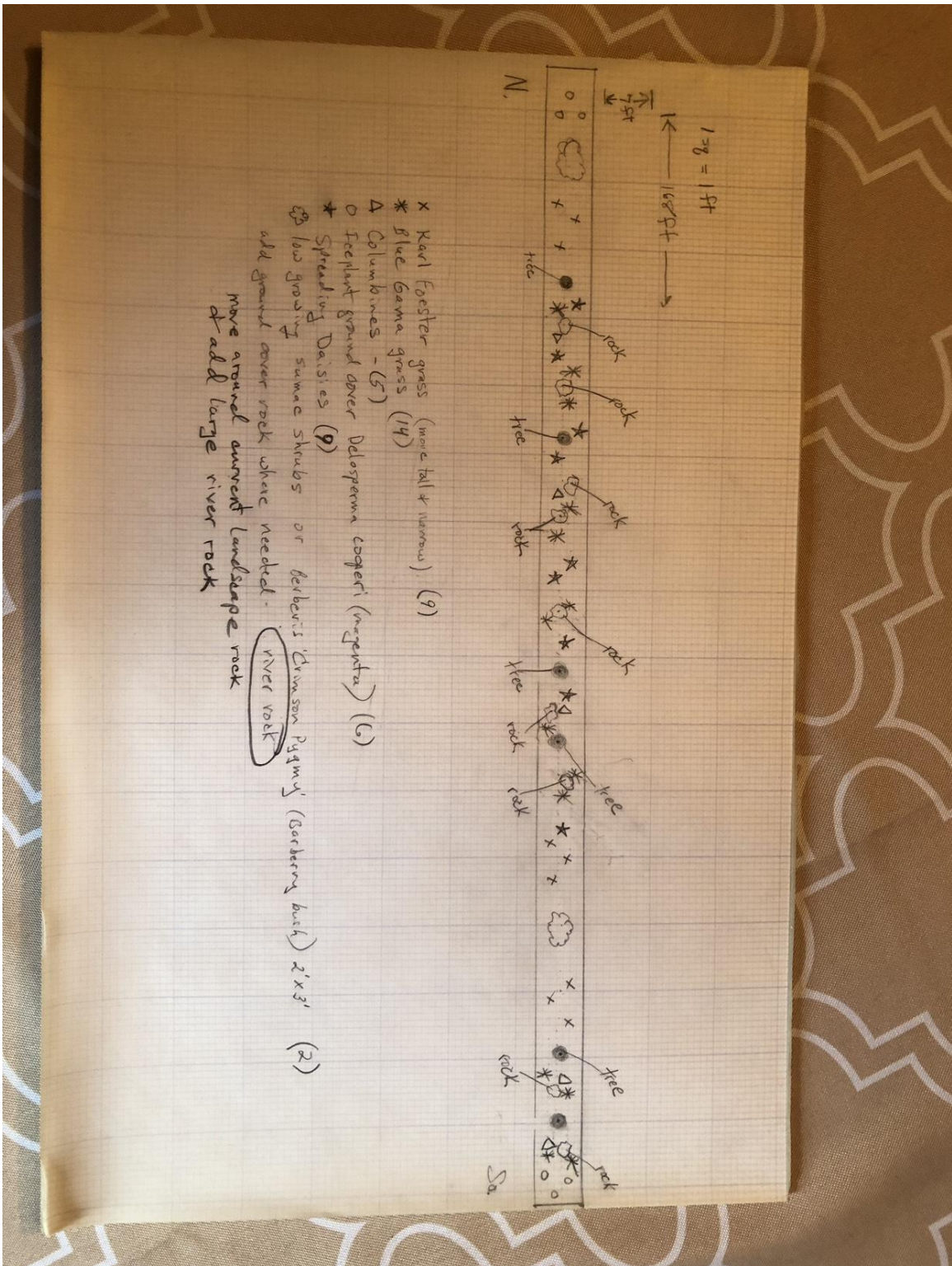

Figure 2. Landscape plan provided by Michelle.